



HC塑料外壳 Plastic Hoods & Housings

防护等级 Degree of protection : IP65

上壳 侧出线 Hoods, side entry



螺纹 Thread	型号 Type	订货号 Part Number
PG16	HC.P-SE-2B-PG16	09120080527

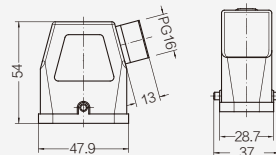

上壳 顶出线 Hoods, top entry



螺纹 Thread	型号 Type	订货号 Part Number
M25	HC.P-TE-2B-M25	19120080429
PG16	HC.P-TE-2B-PG16	09120080427
PG21	HC.P-TE-2B-PG21	09120080429

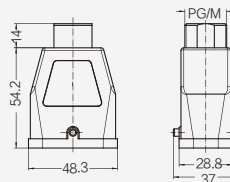

上壳 顶出线 Hoods, top entry



螺纹 Thread	型号 Type	订货号 Part Number
PAFS18	HC.P-TE-2B-PAFS18	09120080428

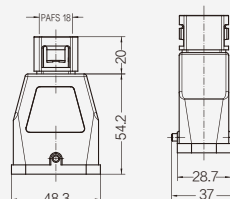

不封底下壳 Housings, bulkhead mounting



螺纹 Thread	型号 Type	订货号 Part Number
---	HC.P-BK-1L-SE	09120080902

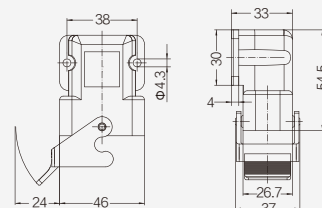

封底下壳 Housings, surface mounting



螺纹 Thread	型号 Type	订货号 Part Number
PG16	HC.P-SF-1L-PG16	09120080901

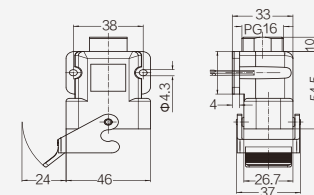

不封底下壳 Housings, bulkhead mounting



螺纹 Thread	型号 Type	订货号 Part Number
---	HC.P-BK-1L	09120080327

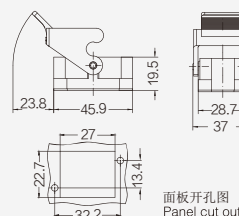

HC塑料外壳 Plastic Hoods & Housings

防护等级 Degree of protection : IP65

飞线下壳 Housings, cable to cable



螺纹 Thread	型号 Type	订货号 Part Number
M25	HC.P-CCT-1L-M25	19120080729
PG16	HC.P-CCT-1L-PG16	09120080727

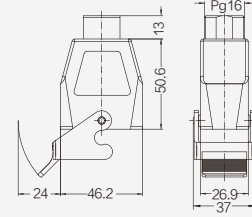

飞线下壳 Housings, cable to cable



螺纹 Thread	型号 Type	订货号 Part Number
PAFS18	HC.P-CCT-1L-PAFS18	09120080728

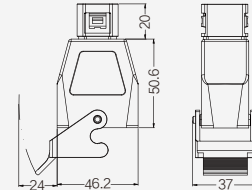

防护盖 Protection covers, metal



螺纹 Thread	型号 Type	订货号 Part Number
---	不带密封圈 Without sealing	
	HC.P-CV-2B/1	09120085407
---	带密封圈 With sealing	
	HC.P-CV-2B/2	09120085408

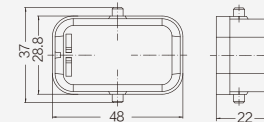

电缆接头 用于上壳 Cable gland, for housings



螺纹 Thread	型号 Type	订货号 Part Number
M25	WNAPC-M25B(D6.5-9.5)	19120005156
M25	WNAPC-M25B(D10.5-14)	19120005157
M25	WNAPC-M25B(D14-17)	19120005158
PG16	WNAPC-PG16B(D11.5-15.5)	09000005059
PG21	WNAPC-PG21B(D14-18)	09000005157
PG21	WNAPC-PG21B(D17-20.5)	09000005158



	cable		SW
	min.	max.	
WNAPC-M25B/ (D6.5-9.5)	6.5 mm	9.5 mm	30
WNAPC-M25B/ (D10.5-14)	10.5 mm	14 mm	30
WNAPC-M25B/ (D14-17)	14 mm	17 mm	30
WNAPC-PG16B/ (D11.5-15.5)	11.5 mm	15.5 mm	27
WNAPC-PG21B/ (D14-18)	14 mm	18 mm	33
WNAPC-PG21B/ (D17-20.5)	17 mm	20.5 mm	33

电缆接头 用于上壳 Cable gland, for housings



螺纹 Thread	型号 Type	订货号 Part Number
PG16	WNAPC-PG16BS(D6.5-9.5)	09000005058
PG16	WNAPC-PG16BS(D11.5-15.5)	09000005057

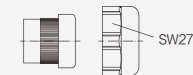

	cable		SW
	min.	max.	
WNAPC-PG16BS/ (D6.5-9.5)	6.5 mm	9.5 mm	27
WNAPC-PG16BS/ (D11.5-15.5)	11.5 mm	15.5 mm	27



HC金属外壳 Metal Hoods & Housings

喷涂Epoxy power paint 防护等级 Degree of protection : IP65

上壳 侧出线 Hoods, side entry



螺纹 Thread	型号 Type	订货号 Part Number
M25	HC-SE-2B-M25	19127080501

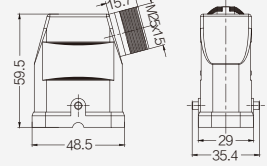

上壳 侧出线 高结构 上下分体式 Hoods, side entry, high construction



螺纹 Thread	型号 Type	订货号 Part Number
M25	HC-SEH-2B-M25	19127080511

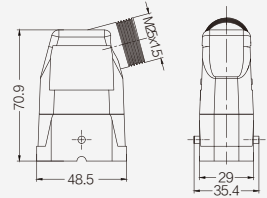

上壳 顶出线 高结构 上下分体式 Hoods, top entry, high construction



螺纹 Thread	型号 Type	订货号 Part Number
M25	HC-TEH-2B-M25	19127080411

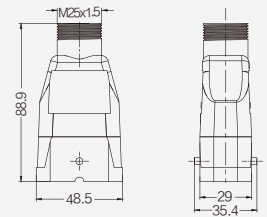

上壳 侧出线 高结构 合盖式 Hoods, side entry, high construction

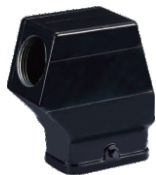

螺纹 Thread	型号 Type	订货号 Part Number
M25	HC-SEHS-2B-M25	19120080526

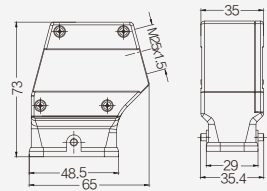

上壳 顶出线 高结构 合盖式 Hoods, top entry, high construction



螺纹 Thread	型号 Type	订货号 Part Number
M25	HC-TEHS-2B-M25	19120080426

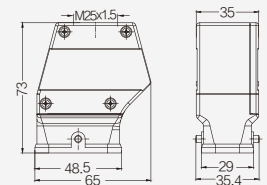

不封底下壳 Housings, bulkhead mounting



螺纹 Thread	型号 Type	订货号 Part Number
---	HC-BK-1L/S	09127080301

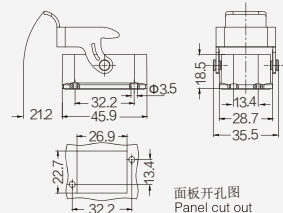

HC金属外壳 Metal Hoods & Housings

喷涂Epoxy power paint 防护等级 Degree of protection : IP65

防护盖 Protection covers, metal

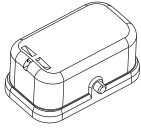

螺纹 Thread	型号 Type	订货号 Part Number
---	不带密封圈 Without sealing	
---	HC-MCV-2B/1	09120085409
---	带密封圈 With sealing	
---	HC-MCV-2B/2	09120085410

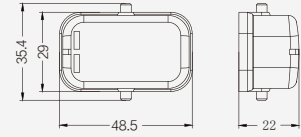

电缆接头 用于上壳 Cable gland, for housings



螺纹 Thread	型号 Type	订货号 Part Number
M25	WNAMC-M25(D10.5-14)	19120005057
M25	WNAMC-M25(D14-17)	19120005058

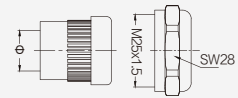

	Ø (线径)	cable		SW
		min.	max.	
WNAMC-M25	10.5-14	10.5 mm	14 mm	28
WNAMC-M25	14-17	14 mm	17 mm	28



HC金属外壳 Metal Hoods & Housings

镀铬Chromated 防护等级 Degree of protection : IP65

上壳 侧出线 Hoods, side entry

 螺纹 Thread
 M25

 型号 Type
 C.HC-SE-2B-M25

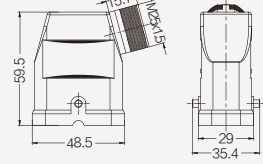
 订货号 Part Number
 19120080501

上壳 侧出线 高结构 上下分体式 Hoods, side entry, high construction

 螺纹 Thread
 M25

 型号 Type
 C.HC-SEH-2B-M25

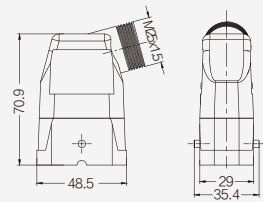
 订货号 Part Number
 19120080511

上壳 顶出线 高结构 上下分体式 Hoods, top entry, high construction

 螺纹 Thread
 M25

 型号 Type
 C.HC-TEH-2B-M25

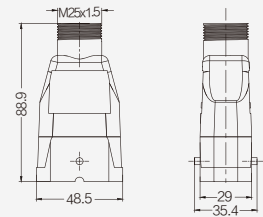
 订货号 Part Number
 19120080411

上壳 侧出线 高结构 合盖式 Hoods, side entry, high construction

 螺纹 Thread
 M25

 型号 Type
 C.HC-SEHS-2B-M25

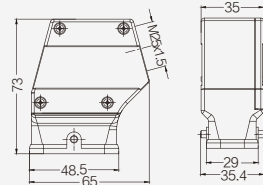
 订货号 Part Number
 19120080527

上壳 顶出线 高结构 合盖式 Hoods, top entry, high construction

 螺纹 Thread
 M25

 型号 Type
 C.HC-TEHS-2B-M25

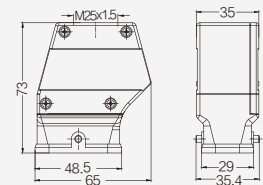
 订货号 Part Number
 19120080427

不封底下壳 Housings, bulkhead mounting

 螺纹 Thread

 型号 Type
 C.HC-BK-1L/S

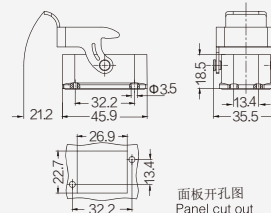
 订货号 Part Number
 09120080301

 面板开孔图
 Panel cut out



HC金属外壳 Metal Hoods & Housings

镀铬Chromated 防护等级 Degree of protection : IP65

防护盖 Protection covers, metal



螺纹 Thread	型号 Type	订货号 Part Number
---	不带密封圈 Without sealing	
---	C.HC-MCV-2B/1	09120085411
---	带密封圈 With sealing	
---	C.HC-MCV-2B/2	09120085412

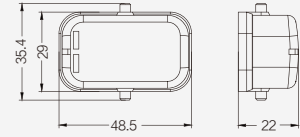

电缆接头 用于上壳 Cable gland, for housings



螺纹 Thread	型号 Type	订货号 Part Number
M25	WNAMC-M25(D10.5-14)	19120005057
M25	WNAMC-M25(D14-17)	19120005058

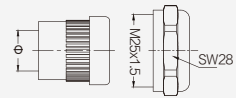

	Φ (线径)	cable		SW
		min.	max.	
WNAMC-M25	10.5-14	10.5 mm	14 mm	28
WNAMC-M25	14-17	14 mm	17 mm	28



HC金属外壳(EMC) Metal Hoods & Housings(EMC)

镀镍 Nickel plating 防护等级 Degree of protection : IP65

上壳 侧出线 Hoods, side entry



螺纹 Thread	型号 Type	订货号 Part Number
M25	EMC.HC-SE-2B-M25	19120080502

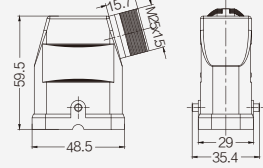

上壳 侧出线 高结构 上下分体式 Hoods, side entry, high construction



螺纹 Thread	型号 Type	订货号 Part Number
M25	EMC.HC-SEH-2B-M25	19120080512

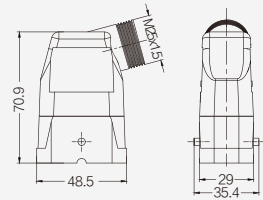

上壳 顶出线 高结构 上下分体式 Hoods, top entry, high construction



螺纹 Thread	型号 Type	订货号 Part Number
M25	EMC.HC-TEH-2B-M25	19120080412

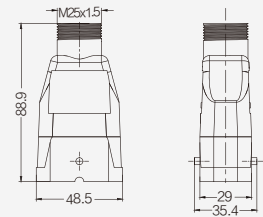

上壳 侧出线 高结构 合盖式 Hoods, side entry, high construction



螺纹 Thread	型号 Type	订货号 Part Number
M25	EMC.HC-SEHS-2B-M25	19120080528

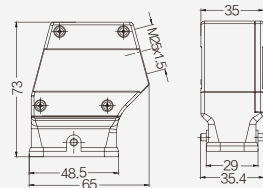

上壳 顶出线 高结构 合盖式 Hoods, top entry, high construction



螺纹 Thread	型号 Type	订货号 Part Number
M25	EMC.HC-TEHS-2B-M25	19120080428

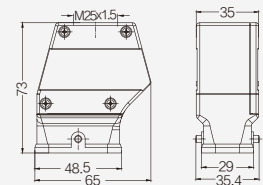

不封底下壳 Housings, bulkhead mounting



螺纹 Thread	型号 Type	订货号 Part Number
---	EMC.HC-BK-1L/S	09120080303

