

面板开孔图  
Panel cut out

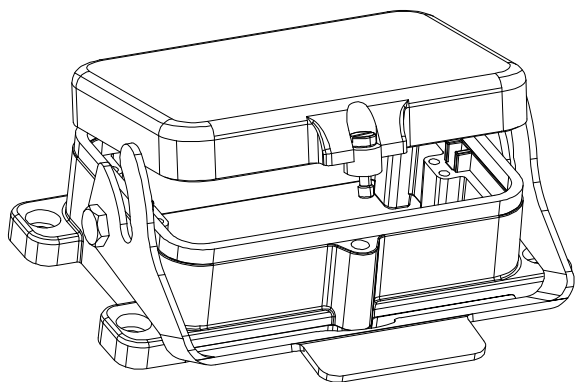

技术参数:

- 材料: 压铸铝
- 盖子材料: PC
- 表面处理: 粉末喷涂
- 颜色: Grey (灰色)
- 温度范围:  $-40^{\circ}\text{C} - +125^{\circ}\text{C}$
- 防护等级: IP65 (联锁状态, IEC 60529)
- 联锁元件:
  - 锁扣方式: 单扣
  - 材料: 不锈钢
- 出线方向: 底部出线
- 密封元件: NBR

Technical specification:

- Material: Aluminium die-cast
- Material, cover: PC
- Surface: powder-coated
- Colour: (grey)
- Temperature range:  $-40^{\circ}\text{C} - +125^{\circ}\text{C}$
- Degree of Protection: IP65  
(acc.to IEC 60529 for coupled connector)
- Locking element:
  - locking type: single locking latch
  - material: stainless steel
- Cable entry: bottom entry
- Hoods/Housings sealing: NBR

<b>ZJKK</b> 浙江昊科电气有限公司 ZHEJIANG HAOKE ELECTRICAL CO.,LTD		图号 Drawing No:		/			
产品代号 Part Code:		H48B-BK-1L-CV		产品料号 PART NO: 09300480301			
Date:	2018.08.16	Scale	REV	Weight	Qty	Drawn:	SHEET
	All Dimensions in mm Original Size DIN A 4	1:2	HK-1	/	/	Tang	1/1